

HORSEPOWER

	GAS 2200 rpm	DIESEL 2200 rpm
Bare engine hp*	62.3	62.3
Net flywheel hp* includes fan, muffler, air cleaner, radiator ..	60.3	60.8
Net flywheel hp (IEMC)	56.5	57.0
Drawbar hp (Mfg. estimate observed)		
with 8-speed transmission	46.0	46.0
with 10-speed transmission	44.0	43.5
Drawbar pull	6,063	6,063
PTO hp (Manufacturer's estimate, maximum observed)		
with 8-speed transmission	52.0	52.0
Engine torque* (fully equipped engine)		
At rated speed, lb-ft.	143.9	145.1
Maximum torque,* lb-ft (fully equipped engine)	171.8	163.3
At engine speed, rpm	1,100	1,300
Displacement, cu. in.	201	201

*Manufacturer's estimate, maximum corrected.

GASOLINE ENGINE

Type—In-line vertical, overhead valve. No. of cylinders: 3. Rated speed: 2,200 rpm. Bore: 4.4 in. Stroke: 4.4 in. Displacement: 201 cu. in. Compression ratio: 7.75:1.

Cylinder block—Extra heavy (234 lbs.) with deep skirts and heavy ribs for rigidity. Extra wide flanges not only add rigidity, but give greater gasket areas to help maintain secure sealing against oil leaks.

Crankshaft—Nodular iron, with four hardened, main bearing journals. Journal length: 1.46 in. Diameter: 3.37 in. Total main bearing area per piston: 20.58 sq. in. Crank pin length: 1.68 in. Diameter: 2.75 in. **Connecting rods**—Massive, forged I-beam. Piston bushing, bronze on steel

backing. **Main bearings**—Sleeve-type, over-plated copper-lead alloy. **Pistons**—Aluminum alloy, fitted with hard, heat-resistant top ring groove insert.

Piston rings—One oil ring and two compression rings per piston. All rings, excepting the lower compression ring, are chrome plated. **Piston pin**—Floating type. Length: 3.5 in. Outside diameter: 1.5 in. **Piston travel**—1,540 fpm, 2,200 engine rpm. **Valves**—Positive rotators on exhaust valves. Nodular iron rocker arms. Intake valve 1.8 in. O.D.; exhaust, 1.51 in. O.D. Opposed intake and exhaust manifolds. Water jacketed, temperature controlled, intake manifold on gasoline model gives better fuel distribution in cold weather, more efficient performance in hot weather. **Camshaft**

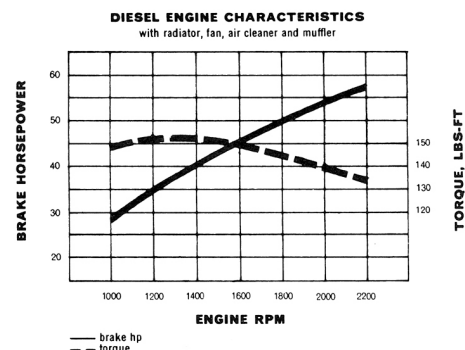
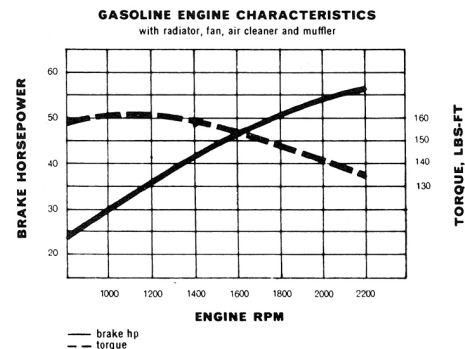

—High-lift, flat follower type. **Cylinders**—Sleeveless design, increases rigidity of block, transfers heat quickly and uniformly to liquid coolant. **Engine lubrication**—Pressurized main system. Gear type oil pump. Gear driven from camshaft. Fixed screen intake. Main bearings, connecting rod

DIMENSIONS:

Ground clearance	
under transmission housing, in.	13.7
under front axle, in.	11.6
Wheelbase, in.	81.1
Turning radius	
with brakes	10' 2"
without brakes	11' 2"
Curb clearance circle, feet	
with brakes	20' 7"
without brakes	23' 9"

Overall length	
to end of lower hitch links, in.	121.4
Overall height,	
over hood, in.	53.7
over steering wheel, in.	58.1
Overall width, 56-in. tread, in.	70.8
Front wheel tread, fixed, in.	56.0
Rear wheel tread	
adjustment range, in.	56-76

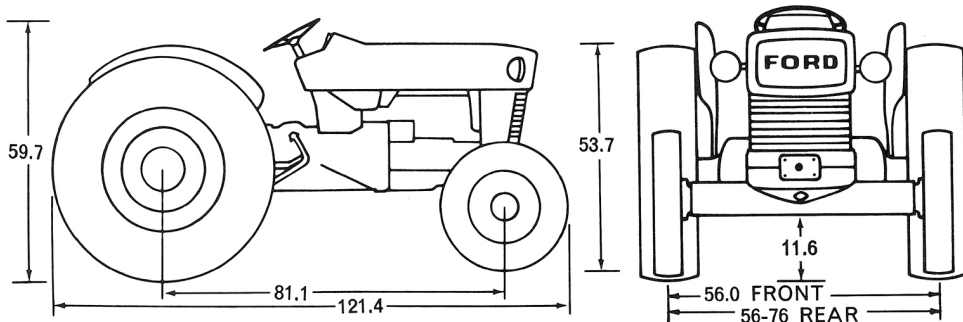

CAPACITIES

Fuel tank, gal.	16.0
Engine lubrication, with filter, qt.	8.0
Transmission, qt.	
Manual reversing 6x4	13.2
8-speed	13.2
10-speed (refill)	11.0
Cooling system, qt.	14.0
Rear axle and hydraulic system, qt.	33.6

Weight distribution—including fuel to capacity, oil, water

	GAS	DIESEL
Front axle, lb.	1,774	1,790
Rear axle, lb.	2,790	2,802
Total, lb.	4,564	4,592
Shipping weight, including oil, water, 3.5 gal. gasoline or 10.0 diesel fuel.	4,483	4,550